

Proposed Wall Build-Up to Achieve Compartmentation

**Barnet
Homes**

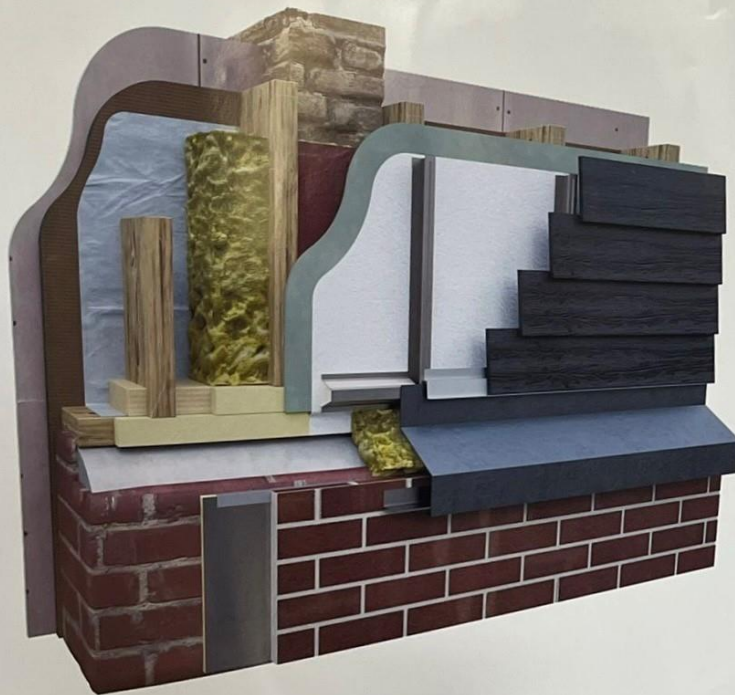

- Cavity barriers will be installed at the party wall line to stop the spread of fire between houses
- New A1 rated non-combustible mineral wool insulation will be installed in between existing studs within the core of the wall to significantly reduce heat loss
- New non-combustible A1 rated cement sheathing board and A2 rated non-combustible fibre cement cladding will be fitted to replicate existing (example shown for Type 1 only in black weatherboard woodgrain)
- Aluminium rails will be used to support fibre cement cladding as a non-combustible support solution